

DISPOSITION DES SALLES

TYPES OF ROOMS ARRANGEMENTS

NIVEAU / LEVEL 1

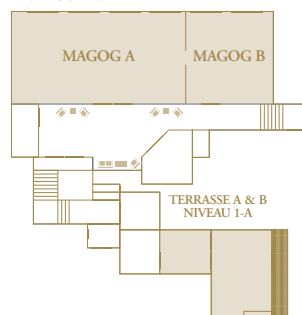

NIVEAU / LEVEL 1-B

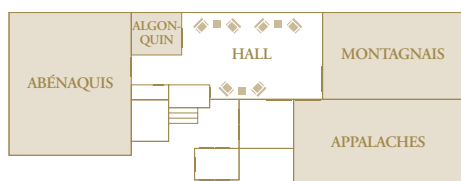

NIVEAU / LEVEL 3



NIVEAU / LEVEL 2

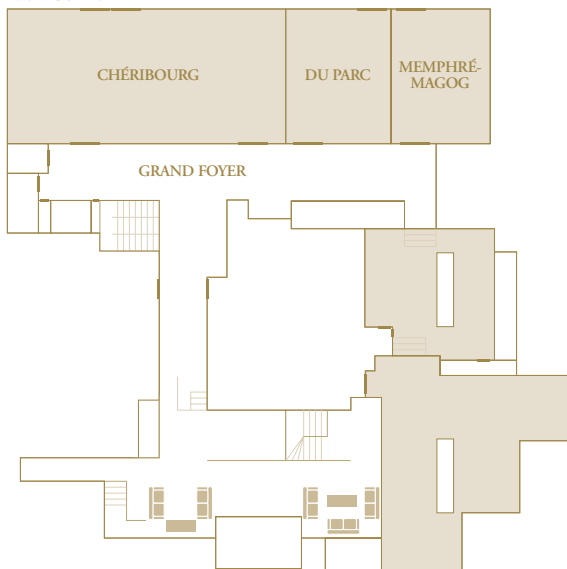

CAPACITÉ DES SALLES

MEETING ROOM CAPACITY



Salles	Dimensions ^(p²)	Hauteur ^(p⁰)	Théâtre	École	«U»	Conférence	Banquet Carré 12	Banquet 8 rond 10	Cocktail	Kiosque 8x10	
Rooms	Dimensions	Height	Theater	School	«U»	Boardroom	Square 12	8 Round 10	Cocktail	Booth	
Magog A	91' x 47' (4277 p ²)	16'10"	475	240	90	100	440	-	360	500	28
Magog B	21' x 47' (987 p ²)	-	100	50	20	30	120	96	-	125	4
Bistro	(1440 p ²)	9'	-	-	20	25	90	-	80	150	-
Terrasse A	35' x 23' (805 p ²)	9'	75	40	30	35	60	48	-	75	-
Terrasse B	30' x 42' (1260 p ²)	9'	145	72	40	45	112	96	-	145	-
Terrasse AB	(2065 p ²)	9'	-	-	-	-	-	-	-	-	-
Abénaquis	21' x 28' (588 p ²)	8'6"	60	30	12	14	-	-	-	-	-
Algonquin	8' x 14' (112 p ²)	8'6"	-	-	-	-	-	-	-	-	-
Montagnais	15' x 30' (450 p ²)	8'6"	55	30	30	35	-	-	-	-	-
Des Appalaches	16' x 35' (560 p ²)	8'6"	50	30	20	25	-	-	-	-	-
Chéribourg	80' x 48' (3840 p ²)	11'11"	425	200	90	110	420	-	320	500	26
Du Parc	32' x 48' (1536 p ²)	11'11"	175	84	50	65	144	-	120	200	10
Memphrémagog	32' x 48' (1536 p ²)	11'11"	175	84	50	65	144	-	120	200	10
Grand Foyer	(1606 p ²)	11'11"	-	-	-	-	-	-	440	200	-
Orford	143' x 48' (6864 p ²)	11'11"	775	400	164	200	708	-	560	1000	44
Orford et Grand Foyer	(8376 p ²)	11'11"	4	486	-	-	-	-	700	1200	-
Estrien	31' x 40' (1240 p ²)	10'	140	70	40	45	72	96	-	140	-
Alfred-Desrochers	31' x 15' (465 p ²)	9'	-	-	-	14	-	-	-	-	-
Grande-Coulée	40' x 31' (1240 p ²)	12'	70	40	30	32	48	48	-	100	-